

# P O T T E R Y B A R N

## WIRE WREATH 24 INCHES Assembly instructions

Note: For safe mounting, Pottery Barn recommends the following:

- Pole mounting is best on wall mounting if possible.
- Consult your local hardware store if you have questions regarding the installation of this product.

### Parts included:

1- WIRE WIRE 24 POUCES

### Included:

1 Anchor  
1 Screw

### Tools required for installation:

- Phillips-head
- Screw driver

### Wood Stud Mounting:

1. Mark the location on the wall.
2. Using a Phillips-head screwdriver, drive the screws into the wall at the location. The screws should not be flush to the wall. Leave a gap of about 1/8" between the head of screw and the wall.
3. Hang the Wire Wreath 24 Inch on the screw heads. If it does not fit properly, you may need to adjust the gap between the head of screw and the wall and hang again.

### Dry Wall Mounting:

1. Mark the location on the wall.
2. Using a Phillips-head screwdriver, drive the dry wall anchors directly into the wall at the location. Do not force the dry wall anchors as they are designed to bore a hole into the wall without much pressure.
3. Using a Phillips-head screwdriver, drive the screws into the dry wall anchors. The screws should not be flush to the wall. Leave a gap of 1/8" between the head of screw and the wall.
4. Hang the Wire Wreath 24 Inch on the screw heads. If it does not fit properly, you may need to adjust the gap between the head of screw and the wall, and hang again.

### Illustration

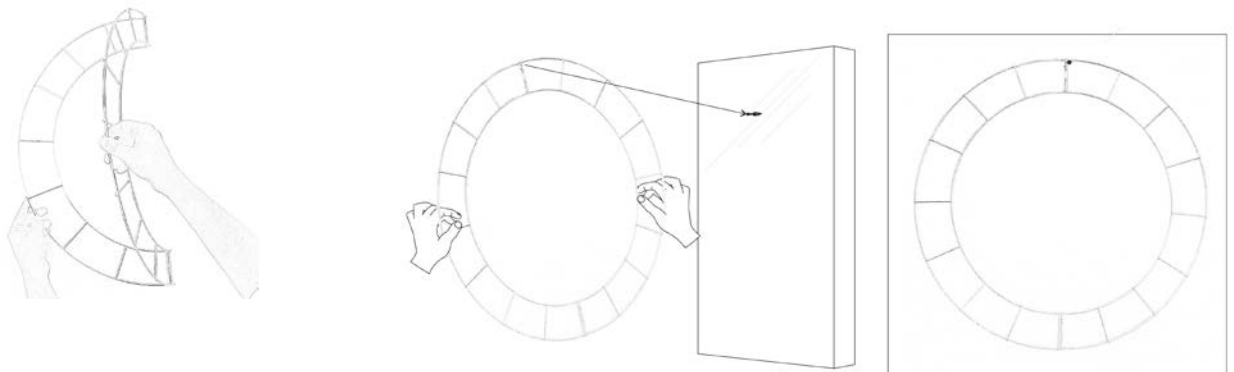

### CARE AND INSTRUCTION:

- Wipe with a soft, dry cloth.
- To protect the finish, do not apply household cleaners or abrasives.

Thank you for your purchase

